

E-Series

Lithium Iron Phosphate Battery

High-performance and durable lithium batteries for electric boating.

Models

E40

2048 Wh / 48 V



E80

4096 Wh / 48 V



E175

8960 Wh / 48 V



Why E-Series Battery



Affordable cost

Unit price is as low as \$0.5 per watt-hour.



High energy density

70% less weight and space than the normal lead-acid battery.



Long life cycles

3000 cycles at 80% DOD.



Made for ePropulsion motors

Data synced with ePropulsion motors to apply smart operation strategy.

Design

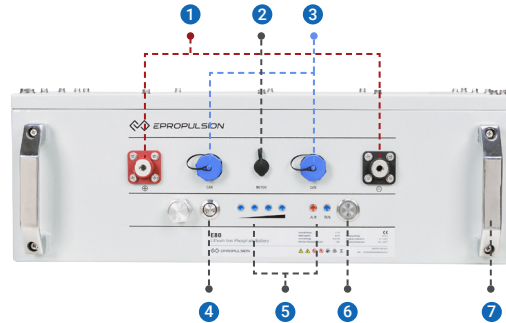

- 1 Discharge and charge port
- 2 Motor communication port
- 3 CAN communication port
- 4 Audible and visual alarm
- 5 State of charge indicator lights
- 6 Power button
- 7 Removable lift handle

Chargers



10A Charger



20A Charger



40A Charger



For safety, ePropulsion E40, E80, and E175 batteries can only be charged by original ePropulsion chargers.

*All chargers are available with 110V and 220V.

E-Series

Lithium Iron Phosphate Battery

High-performance and durable lithium batteries for electric boating.



E40



E80



E175

| Basic | | | |
|------------------------------------|---|---|---|
| Chemistry | Lithium Iron Phosphate | Lithium Iron Phosphate | Lithium Iron Phosphate |
| Rated voltage | 51.2 V | 51.2 V | 51.2 V |
| Capacity | 2048 Wh / 40 Ah | 4096 Wh / 80 Ah | 8960 Wh / 175 Ah |
| Battery Life | 3,000 cycles at 80% DOD | 3,000 cycles at 80% DOD | 3,000 cycles at 80% DOD |
| Physical | | | |
| Weight | 28 kg / 61.7 lbs | 48 kg / 105.8 lbs | 87 kg / 191.8 lbs |
| Dimensions | 42 x 39 x 20.7 cm 16.5 x 15.4 x 8.2 inches | 55.5 x 44 x 21.2 cm 21.9 x 17.3 x 8.4 inches | 50 x 56.5 x 27.7 cm 19.7 x 22.2 x 10.9 inches |
| Terminal Type | M8 | M8 | M8 |
| Electrical | | | |
| Cut-off voltage | 41.6 V | 41.6 V | 41.6 V |
| Final charging voltage | 57.6 V | 57.6 V | 57.6 V |
| Max Continuous Discharging Current | 40 A | 80 A | 150 A |
| Serial Connection | ✗ | ✗ | ✗ |
| Parallel Connection | Up to 16 | Up to 16 | Up to 16 |
| Cell Configuration | 16S1P | 16S2P | 16S1P |
| Charger* | ePropulsion Original 10A or 20A Charger | ePropulsion Original 20A or 40A Charger | ePropulsion Original 20A or 40A Charger |
| Charging Time | 5 hrs (10A Charger) 2.5 hrs (20A Charger) | 5 hrs (20A Charger) 2.5 hrs (40A Charger) | 9 hrs (20A Charger) 5 hrs (40A Charger) |
| Operational | | | |
| Charging Temperature | 0°C to 55°C 32°F to 131°F | 0°C to 55°C 32°F to 131°F | 0°C to 55°C 32°F to 131°F |
| Discharging Temperature | -10°C to 55°C 14°F to 131°F | -10°C to 55°C 14°F to 131°F | -10°C to 55°C 14°F to 131°F |
| Mounting Position | Upright or either long side | Upright or either long side | Upright or either long side |
| Features | | | |
| Communication | Available: CAN-Bus for Parallel, RS485 for ePropulsion motors. N/A: NMEA 2000 | Available: CAN-Bus for Parallel, RS485 for ePropulsion motors. N/A: NMEA 2000 | Available: CAN-Bus for Parallel, RS485 for ePropulsion motors. N/A: NMEA 2000 |
| Shipping Classification | UN3480, Class 9, UN38.3 Certified | UN3480, Class 9, UN38.3 Certified | UN3480, Class 9, UN38.3 Certified |
| Battery Management System | ✓ | ✓ | ✓ |
| Approvals | CE, CCS | CE, CCS | CE, CCS |
| Warranty (Non-commercial use) | 2 years | 2 years | 2 years |

* 3rd-party chargers are not recommended.